

The Enerdoor surge arrester EMG (G) 20 series provides advanced surge protection. This device is designed for maximum discharge of 40 kA, meets the UL 1449 3rd edition and IEC61643-11:2011 Standards, and includes a visual and remote contact indicator.

GENERAL CHARACTERISTICS

Class category IEC/VDE	II+III / C+D
Operating temperature range	-40°C + 80°C
Operating humidity range	0 ~ 90%
Response time	≤100 ns
Backup fuse (only required if not in the main)	125 Amps gL/gG
Enclosure material	Thermoplastic, UL94 V-0
Mounting	35mm DIN rail according to the EN50022/DIN46277-3 Standard
Max size of connecting wire	Single-strand 35mm ² (or # 2AWG) Multi-strand 25mm ² (or # 4AWG)
Remote alarm contact type	Isolated form C
Switching capability Un/In	AC: 250V/0.5A DC: 250V/0.1A
Max size of connecting wire	Max 1.5mm ² (or #16AWG)

EMG (G) 20	Nominal Voltage Vac L-L (L-N)	Nominal Discharge (In, KA) 8/20		Max Discharge Current (Imax, KA)		Voltage Protection Rated (kV)			Case
		L-N	N-PE	L-N	N-PE	@In	@VPR	N-PE (1.2/50)	
EMG.150-1P20	150	20	-	40	-	<0.6	<0.5	-	1
EMG.275-1P20	275	20	-	40	-	<1.2	<0.8	-	1
EMG.320-1P20	320	20	-	40	-	<1.3	<0.9	-	1
EMG.420-1P20	420	20	-	40	-	<1.6	<1.1	-	1
EMG.150-3P20	150	20	-	40	-	<0.6	<0.5	-	2
EMG.275-3P20	275	20	-	40	-	<1.2	<0.8	-	2
EMG.320-3P20	320	20	-	40	-	<1.3	<0.9	-	2
EMG.420-3P20	420	20	-	40	-	<1.6	<1.1	-	2
EMG.150-4P20	150	20	-	40	-	<0.6	<0.5	-	3
EMG.275-4P20	275	20	-	40	-	<1.2	<0.8	-	3
EMG.320-4P20	320	20	-	40	-	<1.3	<0.9	-	3
EMG.420-4P20	420	20	-	40	-	<1.6	<1.1	-	3
EMGG.150-3P20N20	208 (150)	20	20	40	40	<0.6	<0.5	<0.8	4
EMGG.275-3P20N20	320 (275)	20	20	40	40	<1.2	<0.8	<1.5	4
EMGG.320-3P20N20	400 (320)	20	20	40	40	<1.3	<0.9	<1.5	4
EMGG.420-3P20N20	600 (420)	20	20	40	40	<1.6	<1.1	<1.5	4

ELECTRICAL DIAGRAM

SCHEMATIC 1

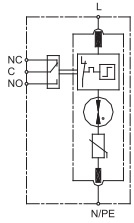

SCHEMATIC 2

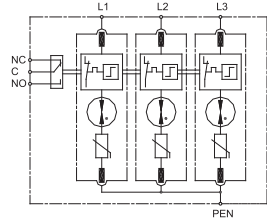

SCHEMATIC 3

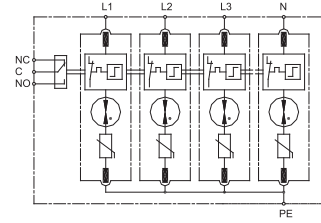

SCHEMATIC 4

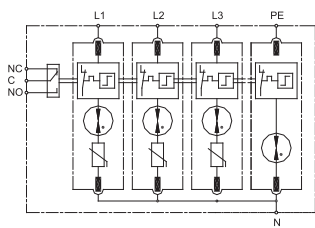

MECHANICAL DIMENSIONS (mm)

CASE 1

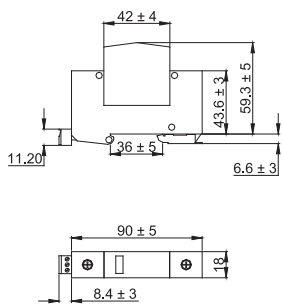

CASE 2

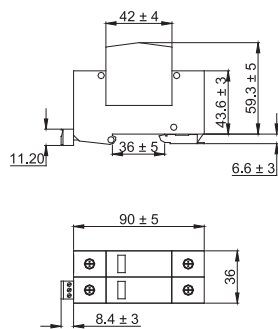

CASE 3

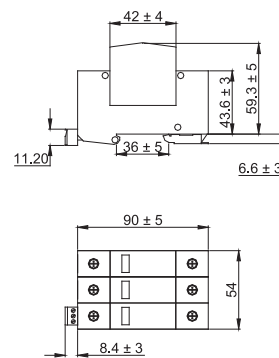

CASE 4

