

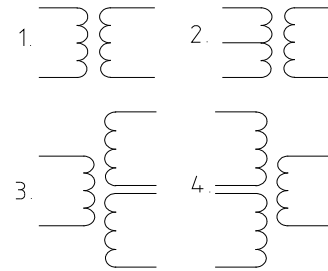

**ELECTRIC CHARACTERISTICS**

|                          |          |
|--------------------------|----------|
| Rated frequency          | 50/60 Hz |
| Electric strength        | 4 kV     |
| Insulation class         | B        |
| Max. ambient temperature | 70 °C    |

**ELECTRIC DIAGRAM**

| EI 30     | Max. output power (VA) | PRI (V) | SEC (V) | Short circuit protection           |
|-----------|------------------------|---------|---------|------------------------------------|
| -X10/...  | 1                      | 24-440  | 3-48    | Inherently short circuit proof     |
| -X6/...   | 1,8                    | 24-440  | 3-240   | Non-inherently short circuit proof |
| -Y7/...   | 2                      | 24-520  | 3-230   | Inherently short circuit proof     |
| -Y8/...   | 2,4                    | 24-400  | 1,7-24  | Inherently short circuit proof     |
| -Y8F/...  | 2,6                    | 24-250  | 3-24    | Non-inherently short circuit proof |
| -Y9/...   | 2,8                    | 12-440  | 3-33    | Inherently short circuit proof     |
| -Y9F/...  | 2,8                    | 24-400  | 3-33    | Non-inherently short circuit proof |
| -Y10/...  | 3,6                    | 24-230  | 3-24    | Inherently short circuit proof     |
| -Y10F/... | 4,8                    | 115-240 | 3-26    | Non-inherently short circuit proof |

Approved to EN 61558  
Safety class II

**CONNECTION**

Solder pins Ø 0,8 mm

**MECHANICAL DIMENSIONS (mm)**

| EI 30    | A    | B    | C  | D   | E    | H    | L  | Weight (g) | Case |
|----------|------|------|----|-----|------|------|----|------------|------|
| -X10/... | 32,3 | 27,3 | -  | -   | -    | 16,5 | 20 | 44         | O    |
| -X6/...  | 32,3 | 27,3 | -  | -   | -    | 22,9 | 20 | 75         | O    |
| -X6/74.. | 32,3 | 27,3 | -  | -   | -    | 22   | 20 | 75         | O    |
| -Y7/...  | 32,3 | 27,3 | -  | -   | -    | 24,7 | 20 | 85         | O    |
| -Y7/...  | 33,2 | 28,9 | 40 | 2,7 | 47,2 | 25,8 | 20 | 85         | K    |
| -Y8/...  | 32,3 | 27,3 | -  | -   | -    | 27,3 | 20 | 98         | O    |
| -Y8/...  | 33,2 | 28,9 | 40 | 2,7 | 47,2 | 27,7 | 20 | 98         | K    |
| -Y9/...  | 32,3 | 27,3 | -  | -   | -    | 30,1 | 20 | 117        | O    |
| -Y9/...  | 33,2 | 28,9 | 40 | 2,7 | 47,2 | 30,7 | 20 | 117        | K    |
| -Y10/... | 32,3 | 27,3 | -  | -   | -    | 33,8 | 20 | 140        | O    |

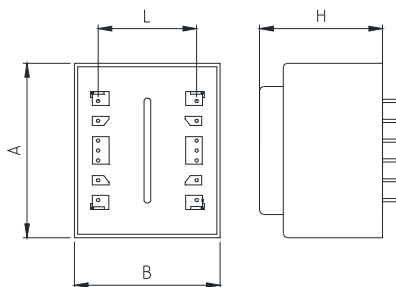
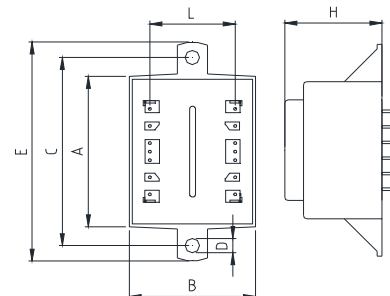
**CASE "O"**

**CASE "K"**

Further versions, prim. or sec. voltages, pin configurations on request.